

## Recommended Tools

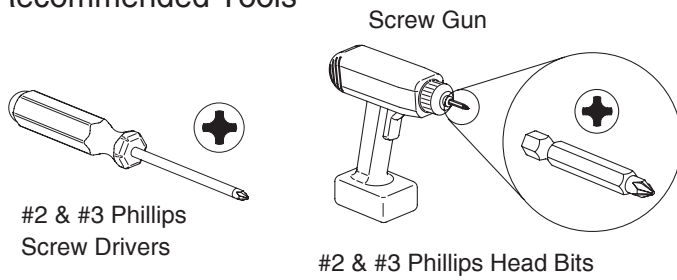

## Lounge Seating Assembly

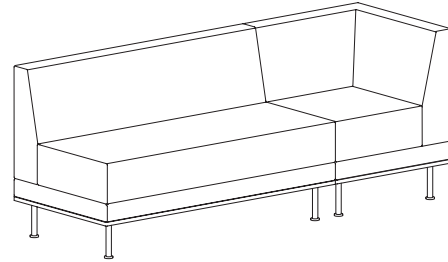

## Package Contents

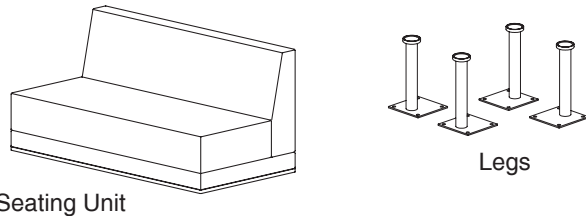

## Hardware Used

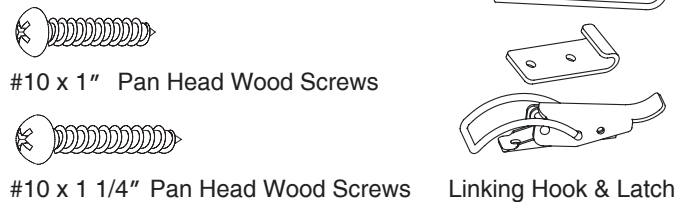

## Step 1

**Attach Legs to Seat:**  
(Note: Units with arms will be shipped with legs factory installed.)

Flip seat over on a flat smooth surface

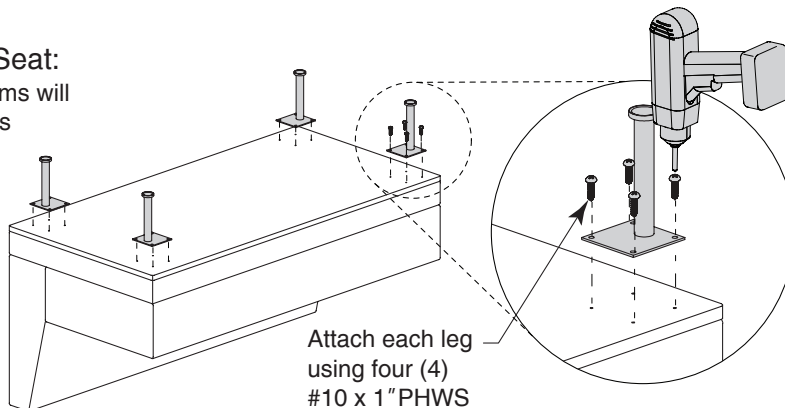

Locking pin is used to keep latch from hang down when not in use.

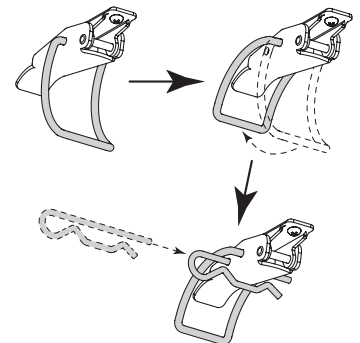

## Step 2

**Attach Ganging Hardware:**  
(when applicable)

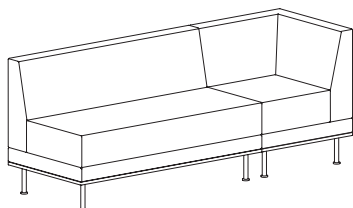

While units are flipped over, attach a set of Linking Hook & Latch Hardware per side. Only one hook & latch is necessary per side when linking seating to casegood units.

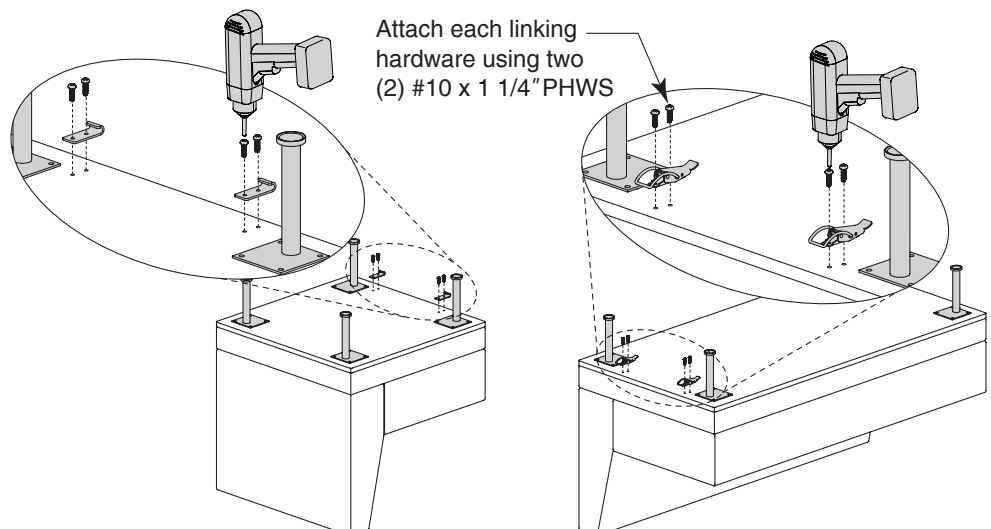

**Notice To Installers:** Failure to comply with installation instructions will compromise the safety, durability and performance of this product, which may risk injury to the user of this product and/or diminish the product life cycle. Jasper Group assumes no liability in these instances.