

Starter Module

- complete assembled frame with attached back, seat and connecting rods

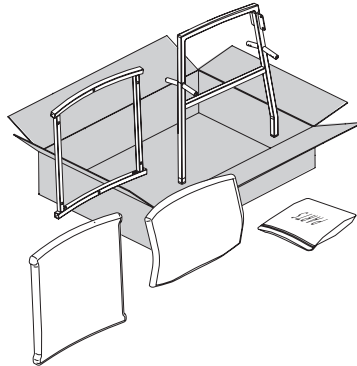

Adder Module

- a kit of parts for center chairs
 1. chair back
 2. chair seat
 3. seat frame
 4. side frame
 5. parts bag

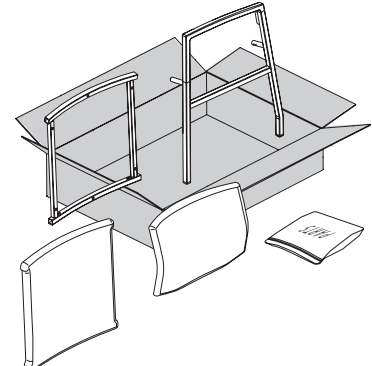

Ender Module

- a kit of parts for ender chair
 1. chair back
 2. chair seat
 3. seat frame
 4. side frame
 5. parts bag

Recommended Tools

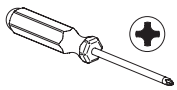

Phillips Driver

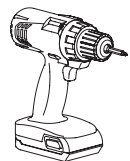

Screw Gun
Phillips Head Bits & Drill Bits



4mm Allen Wrench

Hardware Used

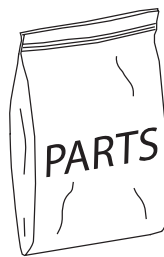

①



②



③



front connecting cap

④

seat box to frames or frame sides



qty of 8

1/4"-20 X 1/2" pan head phillips drive bolt

⑤

seat pan to seat box



qty of 6

#8 X 7/8 flat head phillips drive bolt

⑥

back to back mounting plates



qty of 4

1/4"-20 X 5/8 flat head phillips driver bolt

Step 1

Planning the Layout

- review the layout and identify starter units, adder units, ender units
- take an inventory of all starter units, adder units, ender units and parts
- some layout may have corner tables and or linking brackets both have additional instructions for those items

Notice To Installers: Failure to comply with installation instructions will compromise the safety, durability and performance of this product, which may risk injury to the user of this product and/or diminish the product life cycle. Jasper Group assumes no liability in these instances.

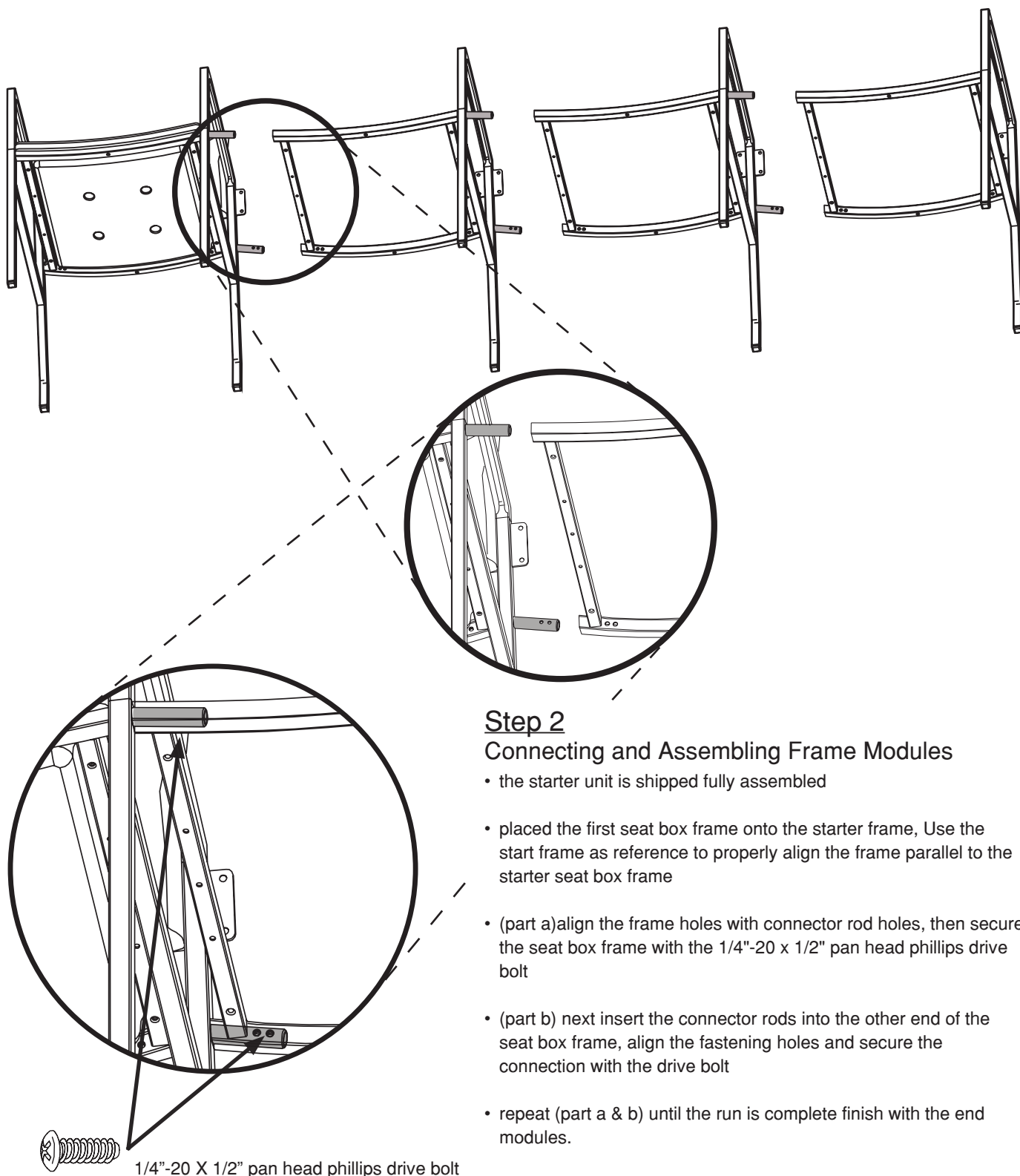

Step 2

Connecting and Assembling Frame Modules

- the starter unit is shipped fully assembled
- placed the first seat box frame onto the starter frame, Use the start frame as reference to properly align the frame parallel to the starter seat box frame
- (part a) align the frame holes with connector rod holes, then secure the seat box frame with the 1/4"-20 x 1/2" pan head phillips drive bolt
- (part b) next insert the connector rods into the other end of the seat box frame, align the fastening holes and secure the connection with the drive bolt
- repeat (part a & b) until the run is complete finish with the end modules.

note for a very large run of modular seatings it is recommended that each section be assembled, and then section be connected together

Notice To Installers: Failure to comply with installation instructions will compromise the safety, durability and performance of this product, which may risk injury to the user of this product and/or diminish the product life cycle. Jasper Group assumes no liability in these instances.



JASPER
GROUP
BRAND

jsifurniture.com
800.457.4511

812.482.3204 O
812.482.1548 F

225 Clay Street / PO Box 231
Jasper, Indiana 47546

Form No. INST-KN003
02/11/19

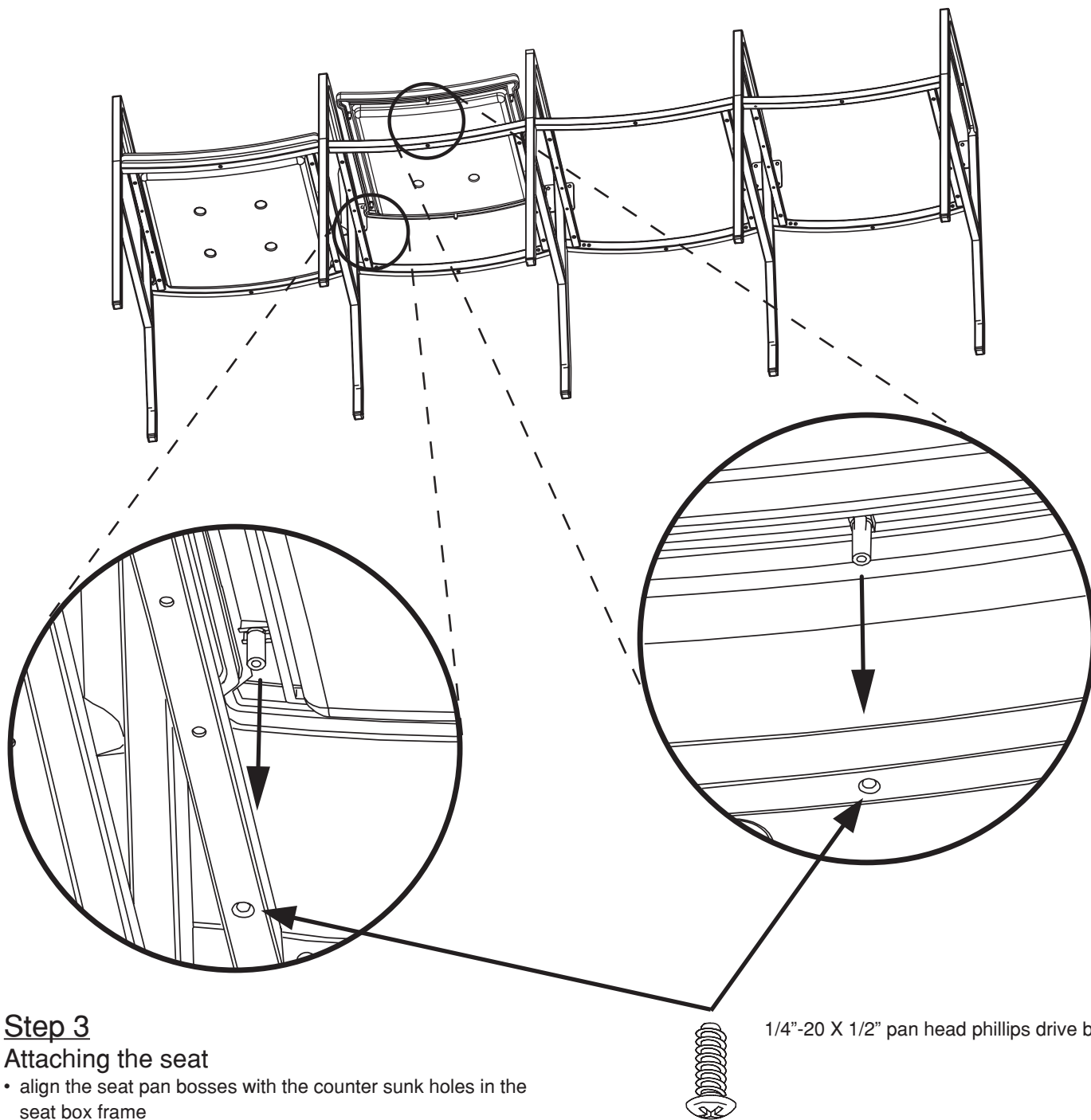

Step 3

Attaching the seat

- align the seat pan bosses with the counter sunk holes in the seat box frame
- place the 1/4"-20 pan head phillips drive bolt into each of the 6 locations with a slight 1/2 turn, recommended that all 6 bolts are tighten by hand using a hand phillips screw driver
- repeat for each seat, make sure all frame connections are secure before you attach the seat.

Notice To Installers: Failure to comply with installation instructions will compromise the safety, durability and performance of this product, which may risk injury to the user of this product and/or diminish the product life cycle. Jasper Group assumes no liability in these instances.

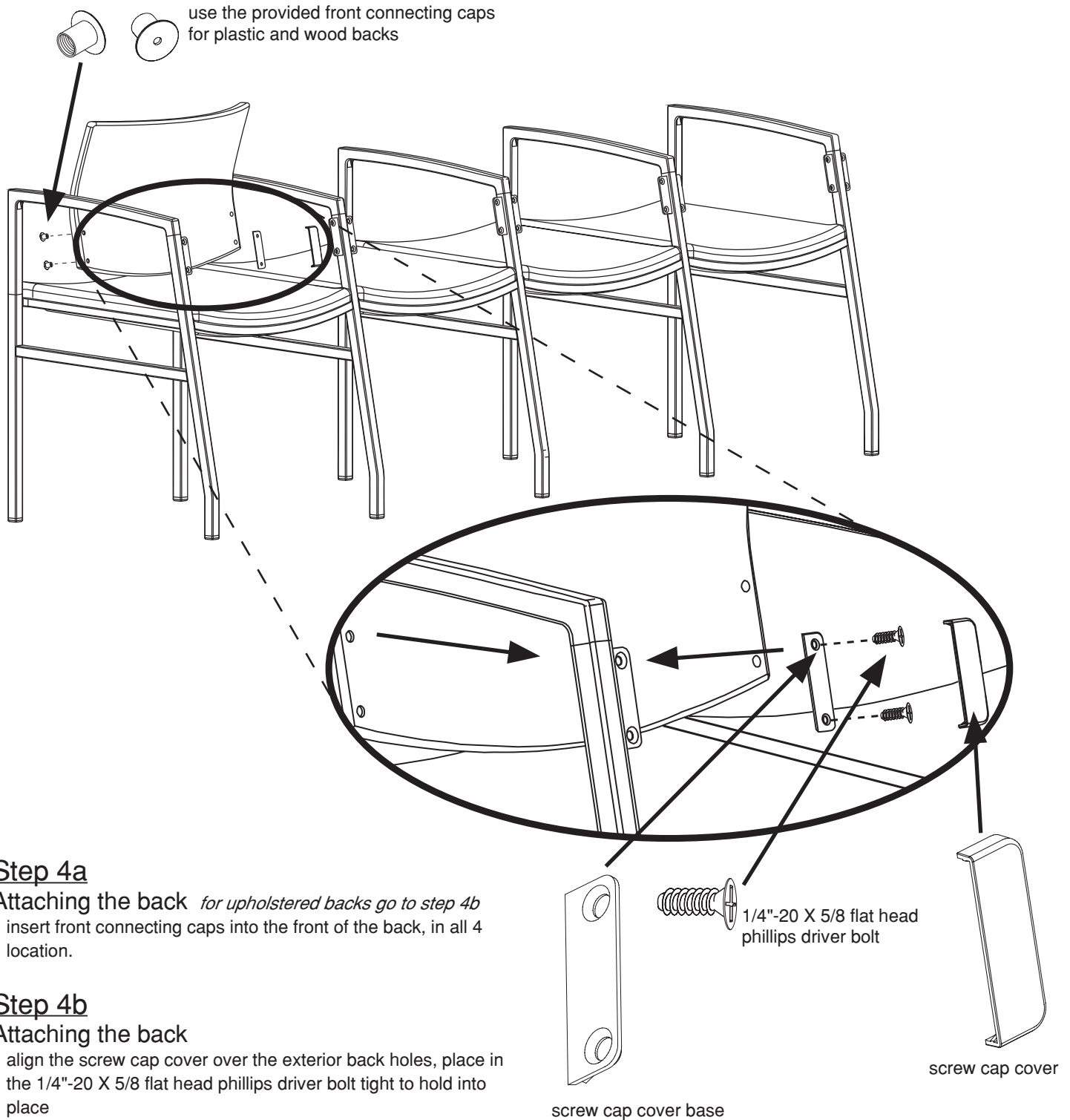

Notice To Installers: Failure to comply with installation instructions will compromise the safety, durability and performance of this product, which may risk injury to the user of this product and/or diminish the product life cycle. Jasper Group assumes no liability in these instances.